



SENSORS &
CONTROLLERS



ANALYZERS
& SAMPLERS



LEVEL, FLOW
& PRESSURE



WEB APP &
DATALOGGING



ACCESSORIES

S423 C OPT T DATASHEET

OPTICAL OXYGEN SENSOR



MAIN FEATURES

- Reliable concentration measurement using optical measuring process
- Dynamic luminescence measuring method
- Titanium sensor body
- Interchangeable cap for luminophore's replacement
- No mechanically moving parts
- Immediate installation and easy maintenance
- Ability to see salinity and barometric pressure for oxygen value

APPLICATIONS

- Measure of oxygen in wastewater
- Measure of oxygen in primary, industrial, recirculating water

TECHNICAL DATA

Materials	• Titanium and PVC body • Special glass optics • NBR and silicon O rings
Thread	1/2" BSP
Measuring ranges	0,00 mg/L to 20,00 mg/L
Measuring method	Optical measure by luminescence
Calibration method	Calibration on air: 1-point calibration, Water saturated with air at 100% Calibration through sample: comparison with a standard tool Calibration on 0% solution: 1-point calibration, specific solution at 0% of oxygen saturation
Resolution	0,01 mg/L
Accuracy	± 0,2 mg/L when < 5mg/L ± 0,3 mg/L when > 5mg/L
Repeatability	± 0,1 mg/L
Response	T90 < 100s
Maximum refreshing time	< 1 second
Working temperature	0÷50 °C Accuracy ± 0.2°C
Max working pressure	5 bar
Max absorption	0,5W
Mechanical protection	IP68 Sensor+cable
Cable	10m integral
Power supply	5...24Vdc
Signal interface	RS-485 Modbus RTU Protocol (4-20mA opt.)
Water move	No necessary move
Compensation of temperature	Via internal NTC
Luminophore diameter	10 mm
Connettore IP67	Yes

DIMENSIONS

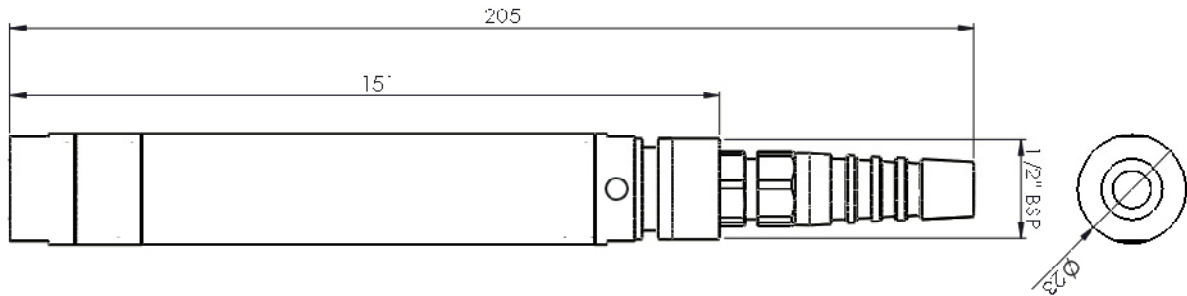

ORDER CODES

9701060067	S423/C/OPT/T Optical Oxygen and Temperature Probe D23 10m cable
9400410700	Luminescent membrane with Titanium support for S423/C/OPT/T D23
9400411114	Fish farming Cap Kit for S423/C/OPT/T D23